

GARLUBIDOR

PHANTOM • User Manual

Say goodbye to digital cold, wake up the music temperature

Table of Contents

Important Safety Precautions.....	3
Instructions for use.....	6
Front Panel Introduction.....	8
Rear Panel Introduction	9
Display Panel Introduction	11
Technical specifications	12
Remote control description.....	15
Common Troubleshooting	17
After-sales service	20

Important Safety Precautions



warnings

Risk of electric shock inside the unit. Do not open the cover.



- To minimise the risk of electric shock, do not remove the outer cover (or back cover).
- If repairs are necessary, they should be carried out by qualified service personnel.
- To avoid fire and electric shock hazards, do not allow the unit to get wet or damp.

- ①. **Read Protective Measures**– Before using the equipment, carefully read all warning information in the instruction manual regarding protection and operation.
- ②. **Follow the instructions for use**– Please follow the operation and use information in the instruction manual, and do not operate in violation of the instruction manual.
- ③. **Keep away from water and humidity**– Do not place the unit near water, such as bathtubs, washbasins, sinks, washing machines, etc.; and do not use it in high-temperature and high-humidity environments, such as damp basements.
- ④. **cleanse**– Do not use liquid cleaners and mist cleaners, clean with a dry cloth. Unplug the unit before cleaning.

Important Safety Precautions

- ⑤. **power supply**—Please use the power supply according to the labelling of the product. The wiring should be arranged reasonably, please do not step on the line, pulling the power cord, so as not to cause damage. Pay special attention to the wires of plugs, convenient sockets and equipment connections.
- ⑥. **Heat Dissipation**—In order to ensure that the product is used reliably, overheating of the device should be avoided, please do not cover cover the device. Do not use the product on surfaces similar to beds, sofas, carpets and other similar surfaces. If the appliance is installed built-in, such as in a bookcase or on a shelf, make sure there is adequate ventilation. Keep a distance of 10cm (4”) on each side,above and behind the appliance. The rear edge of the appliance bracket or upper cover should be 10cm(4”) away from the rear panel or wall to allow space for ventilation and heat dissipation.
- ⑦. **Thermal energy**—Keep the product away from heat sources such as radiators, stoves, and other objects that generate heat (including power amplifiers).
- ⑧. **Lightning**—During thunderstorms, please unplug the power cord to effectively prevent damage from lightning strikes.
- ⑨. **Protection**—Disconnect the power plug when the product is not used for a long period of time.

Important Safety Precautions

- ⑩. **Prevent Foreign Objects or Liquids from Entering**— Care must be taken to prevent objects or liquids from spilling into the device through openings. This is because they may come into contact with electrical currents or live parts, leading to fire or electric shock. This product should not be placed in areas exposed to rain or splashing water, nor should water-containing containers (such as vases) be placed on it.

- ⑪. **Repair**—Users should not attempt to open the casing of the equipment to avoid electric shock. If repair services are required, please send the unit to an authorized service center under the following circumstances:
 - (a) Foreign objects or liquids have entered the unit.
 - (b) The equipment has been exposed to rain.
 - (c) The device operates abnormally.
 - (d) The device has been dropped or physically damaged.

- ⑫. **Disconnecting device**—When the plug, appliance coupler, and power switch are used as the disconnecting device, ensure easy operation.

- ⑬. This product is only safe for use at altitudes below 2000 meters.

- ⑭. This product is only safe for use in non-tropical climates.

Instructions for use

1. Connecting Audio Source and Output Devices

Use appropriate cables to connect your CD player, digital player or computer to the PHANTOM. The analog output port is connected to an amplifier or active speakers.

2. Power On and Input Selection

Make sure the power cord is properly connected and press the front panel STANDBY button to turn on the power. Select the currently used digital input source via the "INPUT" button.

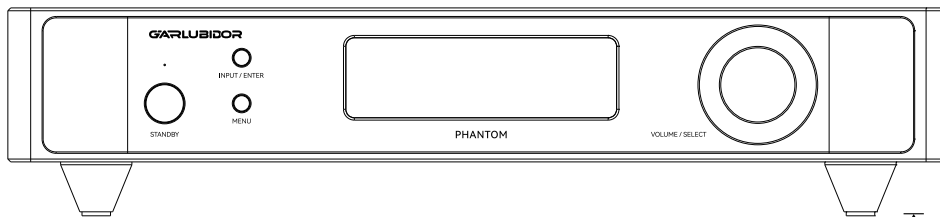

Remote control using a remote control.
Simplifies the operation process.

Effective remote control distance: $\leq 8\text{m}$ Linear remote control, can not be blocked

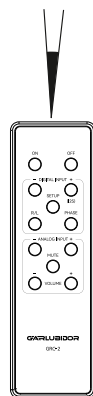

3. Volume Adjustment

Turn the right volume knob to adjust the volume.

4. Playback and Adjustment

Play the music content of the PHANTOM, God will automatically lock the input signal. The display shows the current signal status and volume level in real time.

Front Panel Introduction

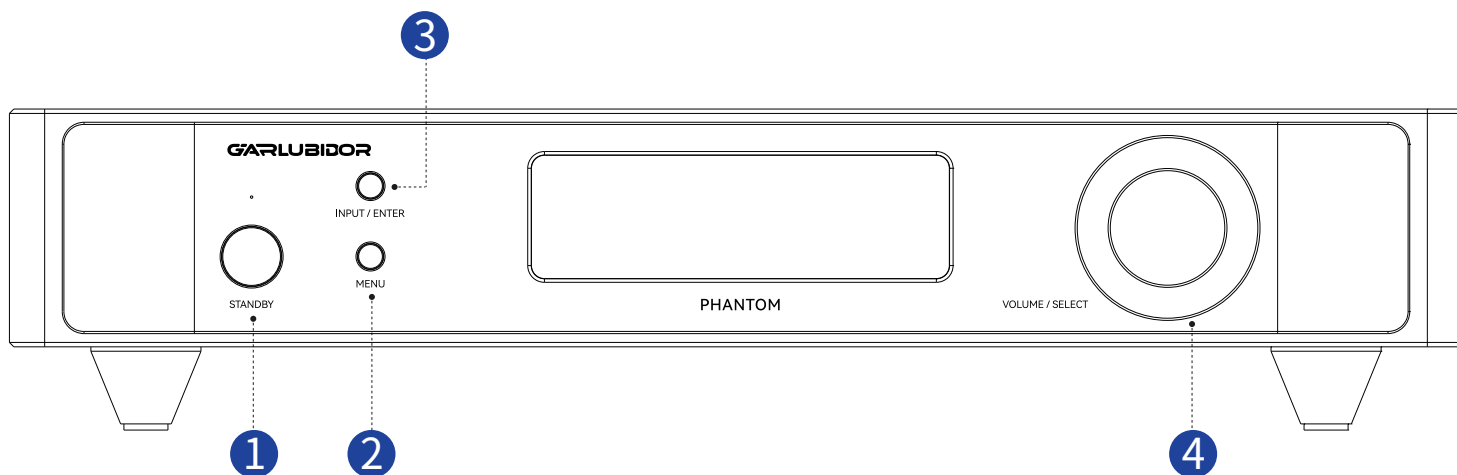

1. Power button

Turns the DAC on and off

2. MENU (menu button)

Enter the device menu settings, use with the knob to adjust system parameters.

3. INPUT / ENTER (input / confirmation key)

Short press can switch the input signal source (such as USB, optical fiber, coaxial, etc.); in the menu mode as a “confirmation” function key, with the menu key and the knob to complete the setup operation. In menu mode, it can be used as the “Confirm” function key, together with the menu key and knob to complete the setting operation.

4. VOLUME / SELECT (Volume knob / Select knob)

Rotate to adjust the volume level and select options in the setup menu. Press the Power button to turn the DAC on or off.

Rear Panel Introduction

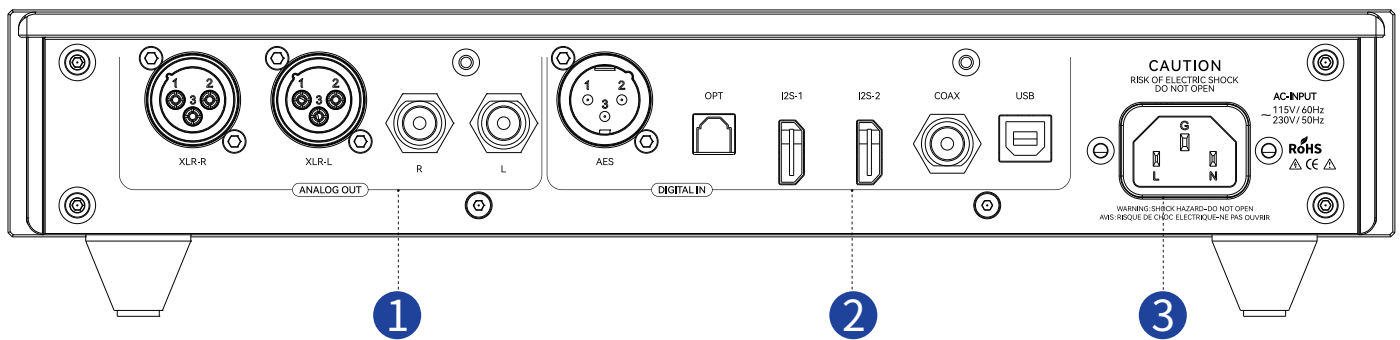

1. Audio signal output

XLR-R: Indicates an analog signal XLR right channel output, connected to the right channel input of the sound system or amplifier.

XLR-L: Indicates the analog signal XLR left channel output, connected to the left channel input of the sound system or amplifier.

RCA-R: Indicates the right channel output of the analog signal RCA, usually marked in red. Connects to the right channel input of the sound system or amplifier.

RCA-L: Indicates the analog signal RCA left channel output, usually marked in white or black. Connects to the left channel input of a sound system or amplifier.

Can be balanced via XLR (1 ground, 2 positive, 3 negative) or single-ended via RCA.

Note: The RCA outputs are connected in parallel to the positive end of the XLR. In order not to affect your listening experience, we do not recommend you to use both RCA and XLR outputs at the same time.

Rear Panel Introduction

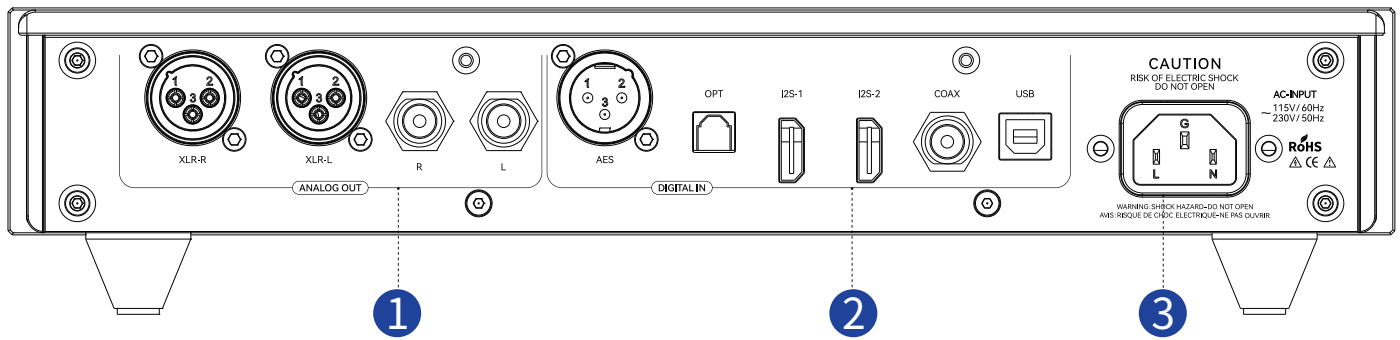

2. Digital Audio Input Connector

COAX: (Coaxial) digital interface, suitable for short distance connection, providing high audio quality.

OPT: (Optical) digital interface, suitable for long distance connection, providing clear audio transmission.

AES: Digital balanced input connector with 110 ohm input impedance

I2S: (HDMI standard line) input interface, different manufacturers wire order may be different, the machine has 8 kinds of wire order selection, can match different manufacturers, the See the function setup instructions method;
Note: Please do not plug and unplug this cable when the machine is on, be careful of static electricity damage to the product.

USB: (Universal Serial Bus) interface, the interface provides convenient digital audio transmission, allowing high fidelity audio data transmission, suitable for connecting to the PC, Mac and various digital audio devices.

3. Power Input Connector

This unit uses a 3-prong power cord, and users need to ensure that the power supply is well grounded; by using the power input connector correctly, you can ensure that the DAC device receives stable and reliable power support.

Display Panel Introduction



Main page description

1. Indicates the output volume level
2. Indicates the current sample rate of the input audio signal. When there is no input signal, it shows No Sig.
3. indicates the phase of the output signal, in-phase is +, reverse is -.
4. indicates the current input audio source, the machine has a total of six audio inputs were (I2S-1, I2S-2, OPT, AES, USB, COAX)



Menu Description

There are 5 setting functions

I2S1 Sets the I2S1 pin sequence.

I2S2 Sets the I2S2 pin sequence.

PHASE Sets the output phase (ON is inverted, OFF is in-phase).

CHANNEL Sets the DSD channel exchange.

USB Update Updates the USB firmware.

Technical specifications

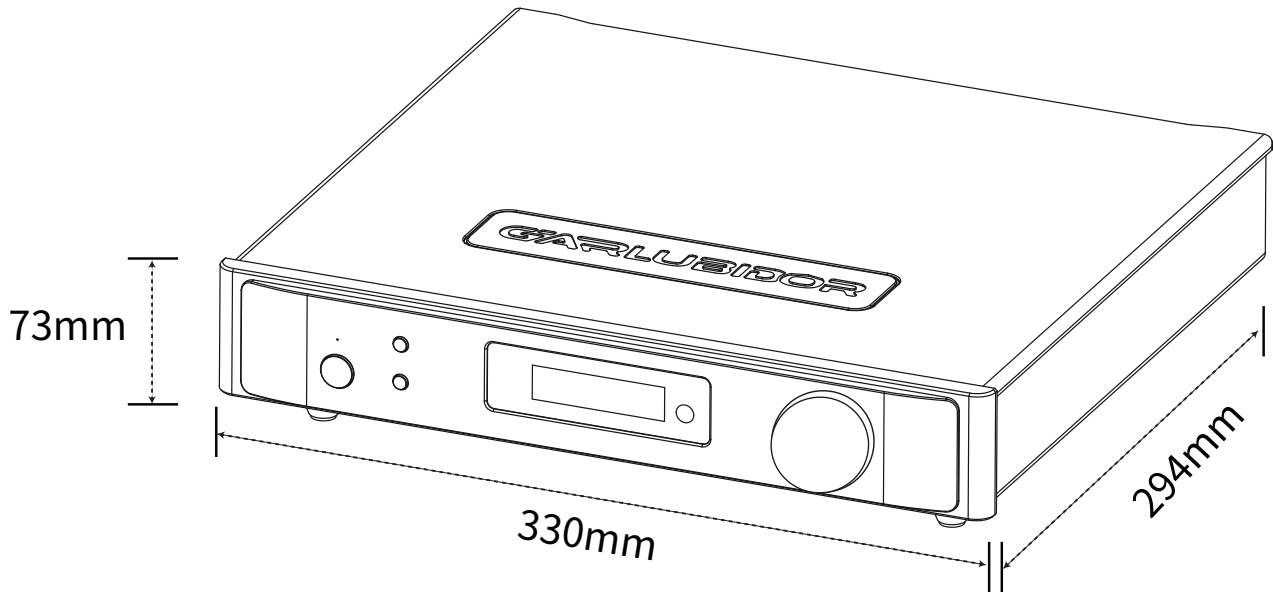

Clarification	Parameters
R-2R DAC	Proprietary R2R + DSD architecture
	Truly balanced 24BIT R2R + 6BIT DSD (32 stage FIR filter)
	Matched precision resistor network array
DSD	COAX/AES/OPT supports DSD64 DSD1024 for USB and I2S inputs only
PCM	Support 44.1KHz, 48KHz, 88.2KHz, 96KHz, 176.4KHz, 192KHz 1536kHz* via USB and I2S input
Digital Inputs	COAX Coaxial OPT Optical AES USB Type B I2S (HDMI Socket)

Technical specifications

Clarification	Parameters
Analog Outputs	RCA 2Vrms , 625 Ω XLR 4Vrms , 1250 Ω
AC Power Requirements	115V AC 60Hz; 230V AC 50Hz
Power Consumption	$\leq 20W$
Frequency Response	20Hz–80 KHz (+1/–3 dB)
THD+N	$\leq 0.002\%$ (A-weighted)
Signal-to-Noise Ratio	≥ 120 dB (A-weighted)
Dynamic Range	≥ 120 dB
Crosstalk	≤ -110 dB
Dimensions	330W x 294Dx 73H mm (Includes feet)
Color	Silver / Black
Warranty	12 months

Technical Specifications

I2S PINOUT						
	DATA		BCK		LRCK	
Mode/PIN	1	3	4	6	7	9
1	DATA-	DATA+	BCK+	BCK-	LRCK-	LRCK+
2	DATA+	DATA-	BCK+	BCK-	LRCK-	LRCK+
3	DATA-	DATA+	BCK-	BCK+	LRCK-	LRCK+
4	DATA+	DATA-	BCK-	BCK+	LRCK-	LRCK+
5	DATA-	DATA+	BCK+	BCK-	LRCK+	LRCK-
6	DATA+	DATA-	BCK+	BCK-	LRCK+	LRCK-
7	DATA-	DATA+	BCK-	BCK+	LRCK+	LRCK-
8	DATA+	DATA-	BCK-	BCK+	LRCK+	LRCK-

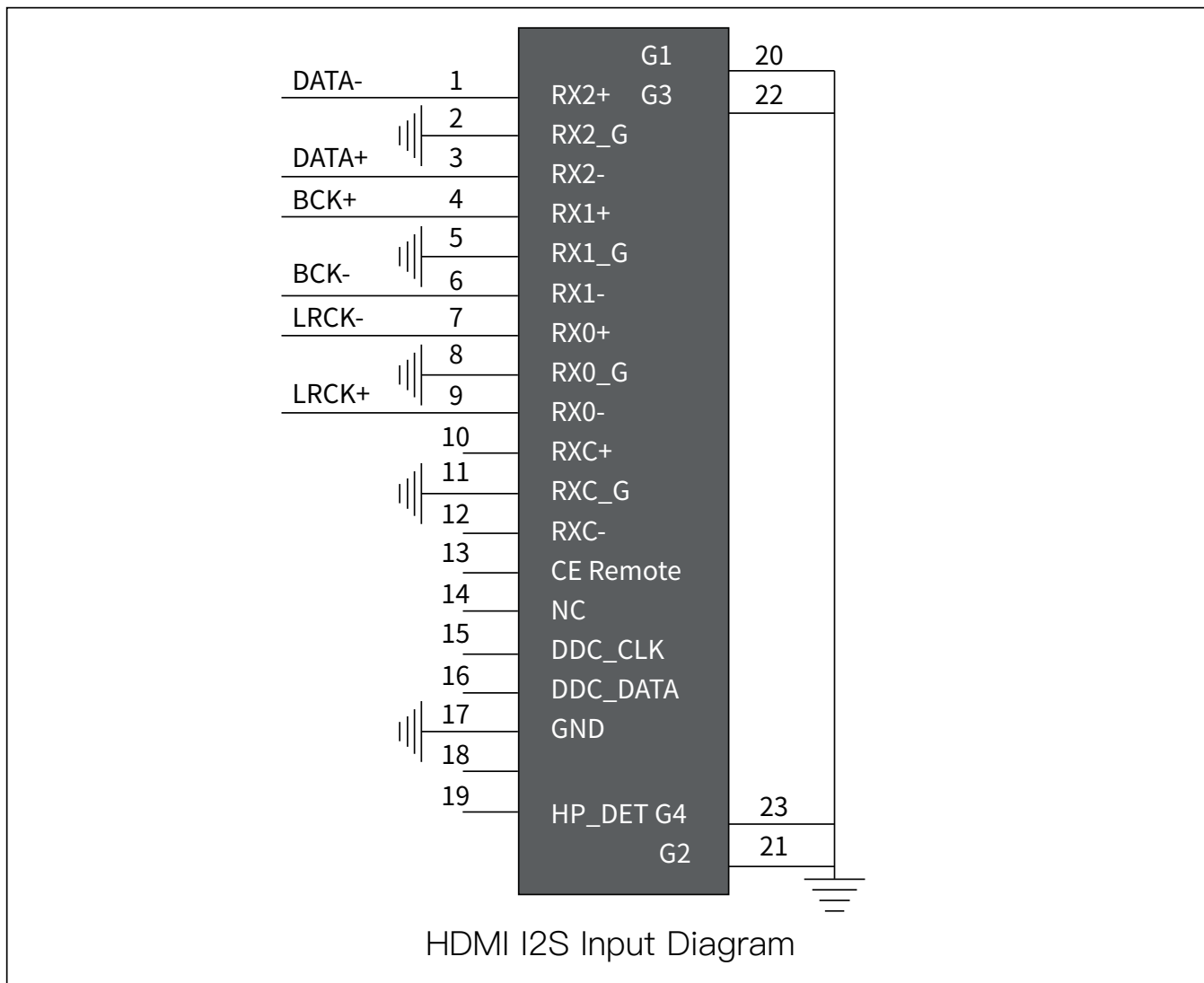

Remote control description

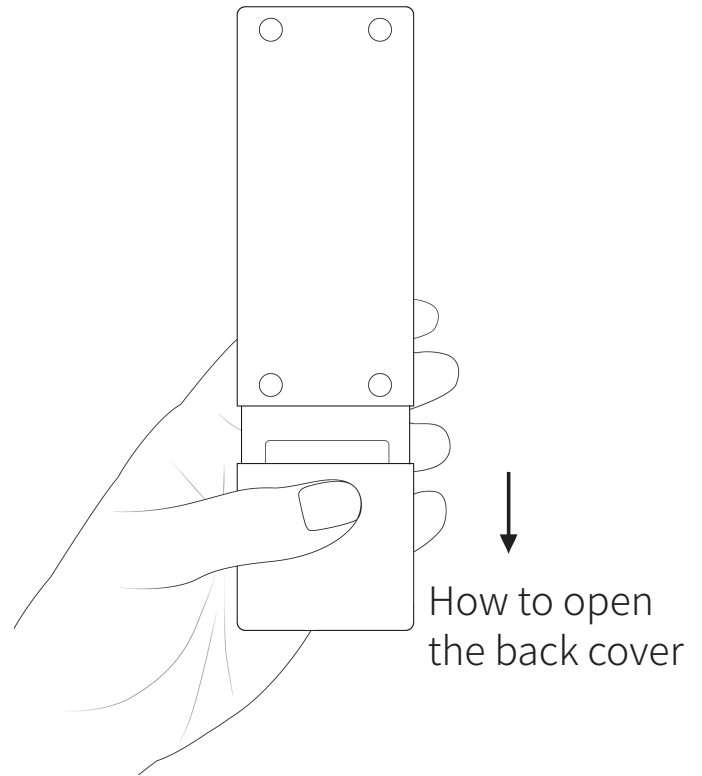
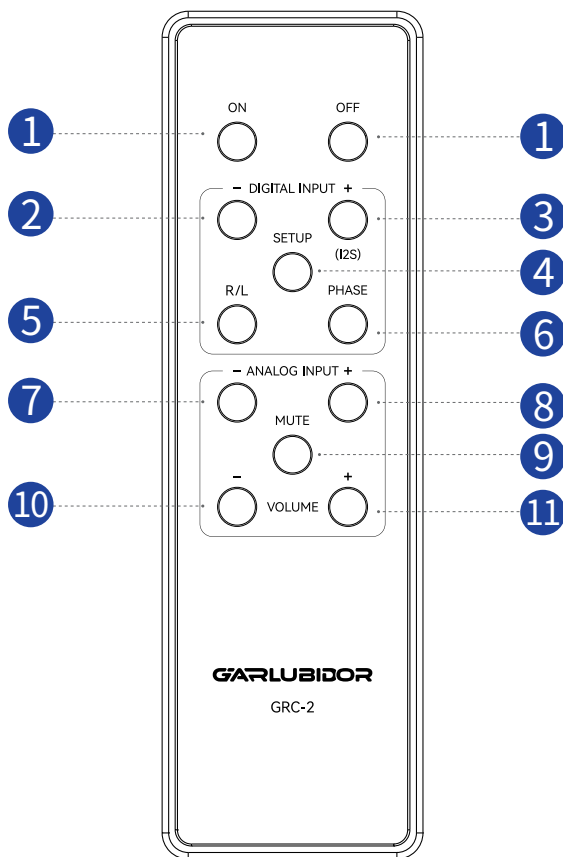

- ①. ON/OFF Button: Turns the device on or off.
- ②. DIGITAL INPUT- Button: Selects digital input audio source.
- ③. DIGITAL INPUT+ Button: Selects digital input audio source.
- ④. SETUP Button: Press once to enter the setting mode. If the device is already in the setting mode, a short press of this button will exit the setting mode.
- ⑤. R/L Button: Swaps DSD left and right channels (not displayed on the home screen of the display).

Remote control description

- ⑥. PHASE Button: Press to switch the phase directly on the panel; "+" for in-phase, "-" for anti-phase.
- ⑦. ANALOG INPUT- Button: Selects analog input audio source.
- ⑧. ANALOG INPUT+ Button: Selects analog input audio source
- ⑨. MUTE Button: Press once to mute (the DAC will have no sound output at the same time); press again to exit mute mode.
- ⑩. VOLUME- Button: Decreases music volume
- ⑪. VOLUME+ Button: Increases music volume

Notes:

- 1. The remote control is an optional accessory.
- 2. One CR2032 button battery is required.
- 3. Due to logistics restrictions, such removable batteries are prohibited from being included in shipments. Therefore, the remote control will be shipped without a battery, and customers are requested to prepare a CR2032 3V button battery by themselves.

Common Troubleshooting

Phenomenon	Solution
A. No sound output	<ol style="list-style-type: none">1. Check all connection cables to make sure the input source is properly connected to the DAC.2. Check the volume setting to ensure that it is not set to mute and that the volume is moderate.3. Replace the data cable or cables to make sure there is no damage.4. Check the DAC's input selections and settings to ensure that the correct input source is selected.
B. Noise or clutter	<ol style="list-style-type: none">1. Use high-quality power cords and power adapters to ensure stable power supply.2. Check all connecting cables and interfaces to ensure good contact.3. Try to avoid placing the DAC in high EMI areas, such as near power cords or next to wireless devices.

Common Troubleshooting

Phenomenon	Solution
C. Sound quality distortion	<ol style="list-style-type: none">1. Make sure the sample rate and format of the input signal match the format supported by the DAC.2. Adjust the DAC's filter and decoder settings to select the appropriate sound quality mode.3. Check all signal cables and connectors to make sure the connections are firm and undamaged.
D. Device will not power on	<ol style="list-style-type: none">1. Check that the power cord and power adapter are properly connected, and make sure there is power to the power outlet.2. Try restarting the DAC, or reconnecting the power supply after a power failure.3. If the problem persists, you can contact the manufacturer and we provide detailed solutions.

Common Troubleshooting

Phenomenon	Solution
E. Input signal not recognized	<ol style="list-style-type: none"><li data-bbox="497 555 1406 734">1. Make sure that the format and sample rate of the input signal matches the format supported by the DAC.<li data-bbox="497 757 1374 936">2. Check the input connector and connecting wires to make sure there is no damage or poor contact.
F. DAC does not recognize USB devices	<ol style="list-style-type: none"><li data-bbox="497 1249 1366 1368">1. Ensure that the latest USB driver for the DAC is installed.<li data-bbox="497 1391 1414 1570">2. Check the USB cable and port to make sure the connection is good and undamaged.<li data-bbox="497 1592 1369 1711">3. Try replacing the USB cable or using a different USB port.

After-sales Service

1. Thank you very much for choosing GARLUBIDOR products. This product comes with a one-year free warranty. During the warranty period, if the product malfunctions due to non-human factors, we will provide free repair or replacement services.

1. Within Warranty Period: Within one year from the date of purchase, under normal use and non-human damage, if there are any product quality or functional issues;

GARLUBIDOR provides free repair or replacement of parts and covers the round-trip shipping costs.

2. Warranty Coverage: Within one year from the date of purchase; excludes damages caused by human factors. Covers any product quality or functional issues;

The specific cost will be determined based on the actual fault and the cost of replacement parts. Please contact our after-sales service email at support@garlubidor.com to obtain a detailed repair quote. The customer shall be responsible for the round-trip shipping costs.

3. After the Warranty Period: Paid repair service will be available after the warranty period expires. We will continue to provide repair services for a fee.

Specific charges will be determined based on the actual fault condition and the cost of replacement parts. Please contact our after-sales service center for a detailed repair quote. The customer is responsible for the round-trip shipping costs.

After-sales Service

2. The product will not be eligible for free warranty service under any of the following conditions:
 - a. The product has exceeded the specified warranty period from the date of purchase.
 - b. The product does not match the model, barcode, or purchase date listed on the warranty card.
 - c. Unauthorized modification or repair of circuits or components by anyone other than GARLUBIDOR technicians.
 - d. Damage caused by human factors (such as dropping, impact, water exposure, fire, etc.).
 - e. Damage caused by irresistible natural forces (such as earthquakes, floods, lightning strikes, etc.).
 - f. Damage caused by exceeding the allowed operating environment.
 - g. Damage caused by improper use or storage (including but not limited to: circuit or component burnout due to excessive voltage; damage to the casing or internal components due to impact; damage caused by excessive dust; product oxidation or corrosion, etc.).
3. This warranty policy applies only to customers who purchase products from the official website. For products purchased from distributors, the warranty terms will be governed by the warranty policy established by the seller.

GARLUBIDOR

Email: support@garlubidor.com

Official website: www.garlubidor.com

